

## NÁJEZDY SKLADEM

TYPY HLAV

STANDART METALMEC



HLAVA G - HÁK



VEZEKO

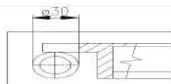

VEZEKO BEZ TRUBKY

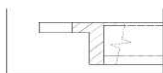

BEZ HLAVY

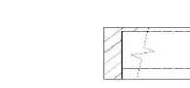

TYPY ŠPICE

STANDART METALMEC



VEZEKO

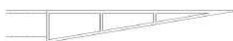

TYP  
HLAVA  
ŠPICE  
ROZMĚRY (VxŠxD)  
MNOŽSTVÍ  
TYP  
HLAVA  
ŠPICE  
ROZMĚRY (VxŠxD)  
MNOŽSTVÍ

**M040B3/15**  
STANDART METALMEC  
STANDART METALMEC  
**40x315x1500**  
2 páry  
**M040B2/25/2**  
STANDART METALMEC  
STANDART METALMEC  
**40x400x2500**  
**1 pár**

CENA **8 000**  
**Kč/ pár**  
NOSNOST 2000 kg

CENA **14 000 Kč**  
NOSNOST **1500 kg**